

PRESSOSTAT
PRESSURE SWITCH
PRESOSTATO

F5

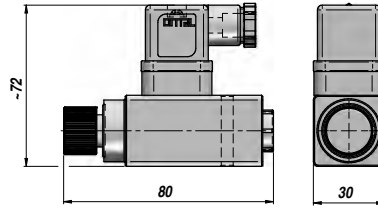
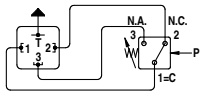

Code Code Código	Type Type Tipo	Orifice Thread Rosca BSP	Plage de Réglage Setting Range Galgas de Reglaje	P MAX bar	Exécution Execution Ejecución	kg
APIF530000	F53		5 > 50 bar	300	Piston	0,15
APIF550000	F55	1/4"	15 > 150 bar	350	Piston	0,15
APIF570000	F57		30 > 300 bar	400	Piston	0,15

MATERIEL - MATERIAL: CORPS - BODY - CUERPO: ALUMINIUM - ALUMINIO

PRESSOSTAT
PRESSURE SWITCH
PRESOSTATO

F4

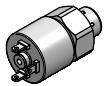
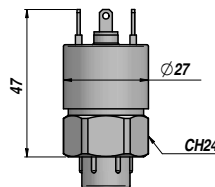
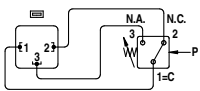

Code Code Código	Type Type Tipo	Orifice Thread Rosca BSP	Plage de Réglage Setting Range Galgas de Reglaje	P MAX bar	Exécution Execution Ejecución	kg
APIF4R10P2	F4R-1-P2		0,2 > 2,5 bar	25	Membrane	0,05
APIF4S10P2	F4S-1-P2		1 > 12 bar	25	Membrane	0,05
APIF4T10P2	F4T-1-P2	1/4"	5 > 50 bar	300	Piston	0,05
APIF4V10P2	F4V-1-P2		10 > 100 bar	300	Piston	0,05
APIF4Z10P2	F4Z-1-P2		20 > 200 bar	300	Piston	0,05

MATERIEL - MATERIAL: CORPS - BODY - CUERPO: ACIER - STEEL - ACERO

MANOMETRE EN BAIN DE GLYCERINE - FIXATION RADIALE
GLYCERINE PRESSURE GAUGE - RADIAL FITTING
MANOMETRO DE PRESION DE GLICERINA - CONEXION RADIAL

AMGR

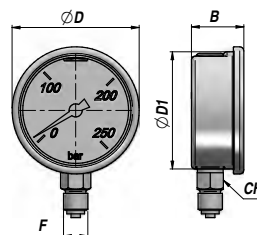

Code Code Código	ØD1	F BSP	Echelle bar Range bar Escala bar	B	CH	ØD	kg
AMGR063010			0 / 10				0,20
AMGR063025			0 / 25				0,20
AMGR063060			0 / 60				0,20
AMGR063100	62,6	1/4"	0 / 100	28	14	68	0,20
AMGR063160			0 / 160				0,20
AMGR063250			0 / 250				0,20
AMGR063400			0 / 400				0,20
AMGR063600			0 / 600				0,20

MATERIEL - MATERIAL: BOITER INOX - STAINLESS STEEL CASING - CARCASA DE ACERO INOXIDABLE